

MV-CH050-10CM

5 MP 2/3" CMOS CameraLink Area Scan Camera



GEN<i>i>CAM



Introduction

MV-CH050-10CM camera adopts Sony IMX250 sensor to provide high-quality image. It uses CameraLink interface to transmit non-compressed images in real time with max. frame rate reaching 140 fps.

Key Feature

- Adopts global shutter CMOS sensor providing high signal-to-noise ratio, wide dynamic range, and high-quality image
- Resolution of 2432 × 2048 and pixel size of 3.45 μm × 3.45 μm
- Supports configuration modes of Base, Medium, Full and 80-bit via the CameraLink interface
- Adopts compact design with mounting holes for flexible mounting

Dimension

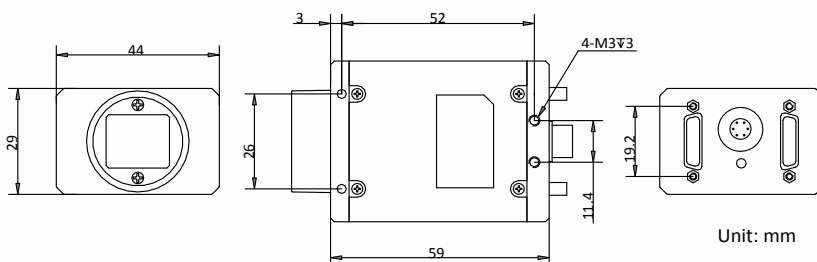

Available Model

Mono camera: MV-CH050-10CM

Applicable Industry

SMT/ PCB AOI, FPD, railway related applications, high-accuracy measurement, etc.

Sensor Quantum Efficiency

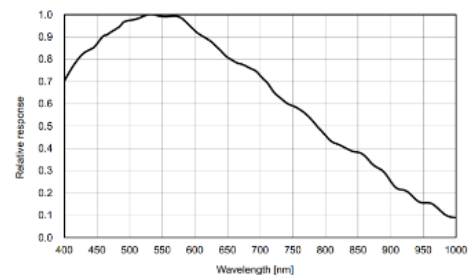

Specification

Model	MV-CH050-10CM			
Parameters	5 MP 2/3" CMOS CameraLink Area Scan Camera			
Camera				
Sensor type	CMOS, global shutter			
Sensor model	Sony IMX250			
Pixel size	3.45 μm \times 3.45 μm			
Sensor size	2/3"			
Resolution	2432 \times 2048			
Pixel clock	60 MHz, 70 MHz, 85 MHz			
Configuration mode	Base	Medium	Full	80-bit
Sensor combination	1X2_1Y	1X4_1Y	1X8_1Y	1X10_1Y
Tap number	2 Taps	4 Taps	8 Taps	10 Taps
Max. frame rate	140 fps @2432 \times 2048			
Pixel format	Mono 8/10/12			
Dynamic range	75.4 dB			
SNR	40 dB			
Gain	0 dB to 20 dB			
Exposure time	15 μs to 10 s			
Shutter mode	Off/Once/Continuous exposure mode			
Binning	Supports 1 \times 1, 1 \times 2, 1 \times 4, 2 \times 1, 2 \times 2, 2 \times 4, 4 \times 1, 4 \times 2, 4 \times 4			
Reverse image	Supports horizontal and vertical reverse image output			
Electrical features				
Data interface	CameraLink with SDR interface			
Digital I/O	6-pin Hirose connector provides power and I/O, including opto-isolated input x 1, opto-isolated output x 1, and bi-directional non-isolated I/O x 1			
Power supply	9 VDC to 24 VDC			
Power consumption	Approx. 3.25 W@12 VDC			
Structure				
Lens mount	C-mount			
Dimension	44 mm \times 29 mm \times 59 mm (1.7" \times 1.1" \times 2.3")			
Weight	Approx. 100 g (0.2 lb.)			
Ingress protection	IP30 (under proper lens installation and wiring)			
Temperature	Working temperature: 0 $^{\circ}\text{C}$ to 50 $^{\circ}\text{C}$ (32 $^{\circ}\text{F}$ to 122 $^{\circ}\text{F}$) Storage temperature: -30 $^{\circ}\text{C}$ to 70 $^{\circ}\text{C}$ (-22 $^{\circ}\text{F}$ to 158 $^{\circ}\text{F}$)			
Humidity	20% to 80% RH, without condensation			
General				
Client software	MVS or frame grabber software meeting with CameraLink V2.0, GenICam Protocol			
Operating system	32/64-bit Windows XP/7/10			
Compatibility	CameraLink, GenICam			
Certification	CE, FCC, RoHS, KC			

HIKROBOT

Hangzhou Hikrobot Technology Co., Ltd.
No.399 Danfeng Road, Binjiang District, Hangzhou 310051, China.
en.hikrobotics.com

Copyright Hikrobot

Hangzhou Hikrobot Technology Co., Ltd. All Rights Reserved. Hangzhou Hikrobot Technology does not tolerate any infringement. Any organization or individual may not imitate or reproduce in whole or in part of the content. The data herein is based on Hikrobot's internal evaluation. Actual data may vary depending on specific configuration and operating condition. The information herein is subject to change without notice. All the content has been checked conscientiously. Nevertheless, Hikrobot shall not be liable to damages resulting from errors, inconsistencies or omissions.